

Courses & Distances
Down the River

- N 13 E -- 72
- N 7 E -- 54
- N 2 W -- 30
- N 5 W -- 26
- N 8 E -- 22.
- 204

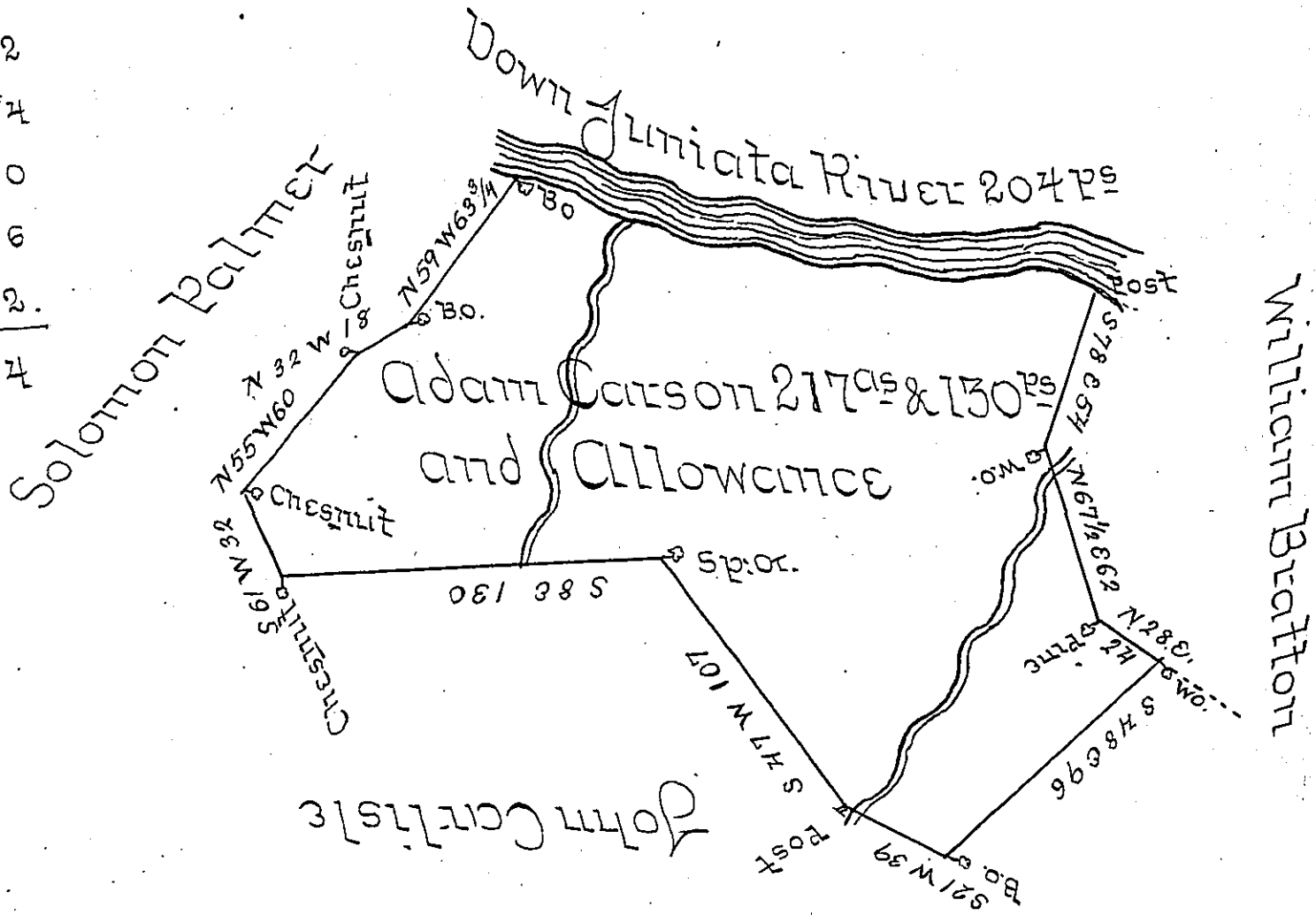

The Draught of a Tract of Land Situate in Wayne Township Cumberland County Containing in the Whole Two Hundred and Seventeen Acres and 130 Perches and Allowance of Six Percent for Roads &c. Resurveyed the 17th Day of April 1767 in Pursuance of a Warrant from the Honourable the Proprietaries No. Adam Carson Dated 10th February 1755 and an Order of Survey to the Same Dated April 22nd 1767 No. 3498 The Quantity Surveyed by the Warrant Contains One Hundred and Ten Acres Adjoining the River and that in Pursuance of the Order Contains One Hundred & Seven Acres & 130^{ps} and Allowance joining the Above

No John Lukens Esq^r }
Surveyor General } Ps Sam^l Lyon D.S.

IN TESTIMONY that the above is a copy of the original remaining on file in the Department of Internal Affairs of Pennsylvania, made conformably to an Act of Assembly approved the 16th day of February, 1838 I have hereunto set my Hand and caused the Seal of said Department to be affixed at Harrisburg, this fifteenth day of December 1905.

Geo. C. Brown
Secretary of Internal Affairs.